

COTTAGE PLACE ADDITION ALLEY SANITARY SEWER IMPROVEMENTS

CONSTRUCTION REVIEW

This newsletter is to inform you of the general contractor working for the City of St. Cloud on this project and give you contact information with the contractor, as well as giving a few friendly reminders for the upcoming construction project.

R.L. Larson Excavating, Inc. is the general contractor working for the City on this project.

During the weekend or after hours, if you know of a construction-related emergency, please call one of the Contractor's representatives for assistance at the following phone numbers:

- Bruce Bayer (320) 980-2521
- Bill Juetten (320) 828-7156
- Wade Larson (320) 980-1603

Please restrict use of these numbers to emergency use only.

Construction Schedule

Construction Timeline:

Estimated start date: June 5, 2017

Utility work completion: Mid August, 2017

Alley paving, driveways, topsoil placement/grading: Late September, 2017

Final completion, including punch list items: May 31, 2018

Sprinkler System and Specialized Landscaping Within City Right-of-Way

As always with a project of this magnitude, construction activities will likely disturb the area within and close to the alley right-of-way.

Residents are strongly encouraged to remove any special landscaping, planters, bushes, etc. out of these areas to ensure they are not damaged during construction before June 5, 2017.

After this date, the City of St. Cloud will have the contractor remove any remaining landscaping in conflict with construction of the project. The City and its contractor will not be held liable for damage or salvaging of any sprinkler system or specialized landscaping within the City right-of-way.

Utility Service Lines

As mentioned in the previous newsletter, under the City improvements, the sanitary sewer mains will be replaced along with sewer services from the main to approximately the property line. **We strongly encourage everyone to review the condition of their individual private service lines now if you have not already done so.** There will be a 4 week window built into the project timeline that will allow residents to replace their existing sanitary sewer services before the alleys are to be paved. Please see the attached map to determine the applicable private service installation window for your property.

Location A - Between July 15th and August 12th

Location B - Between August 12th and September 9th

During the design phase, we have noticed some service lines crossing other private properties. Please check if this is the case with your service. It is your responsibility to reconnect any such service to the new sanitary sewer service connection that the City will provide in front of your property. If your existing lines are in need of replacement, this would be an excellent opportunity to coordinate it with the construction this summer.

Access for Residents and Businesses

The project will be coordinated in an attempt to provide you with access to your property during construction. In a project of this type, access will be difficult at times. We ask for your cooperation and patience. We also ask that special care be taken when traveling through construction zones. By working together, we can minimize any inconveniences and ensure a safe construction site. **If anyone has special access needs, please bring it to our attention so that we can attempt to meet your needs.**

KEY CONTACTS

Remember, if you have questions or need more information; please contact the City of St Cloud, Engineering Department. The two main contacts are:

Resident Representative

Scott Schreiber

320-293-4930

scott.schreiber@ci.stcloud.mn.us

Project Engineer

Zac Borgerding

320-255-7240 office

320-345-0385 cell

Cottage Place Addition Neighborhood Improvements

N

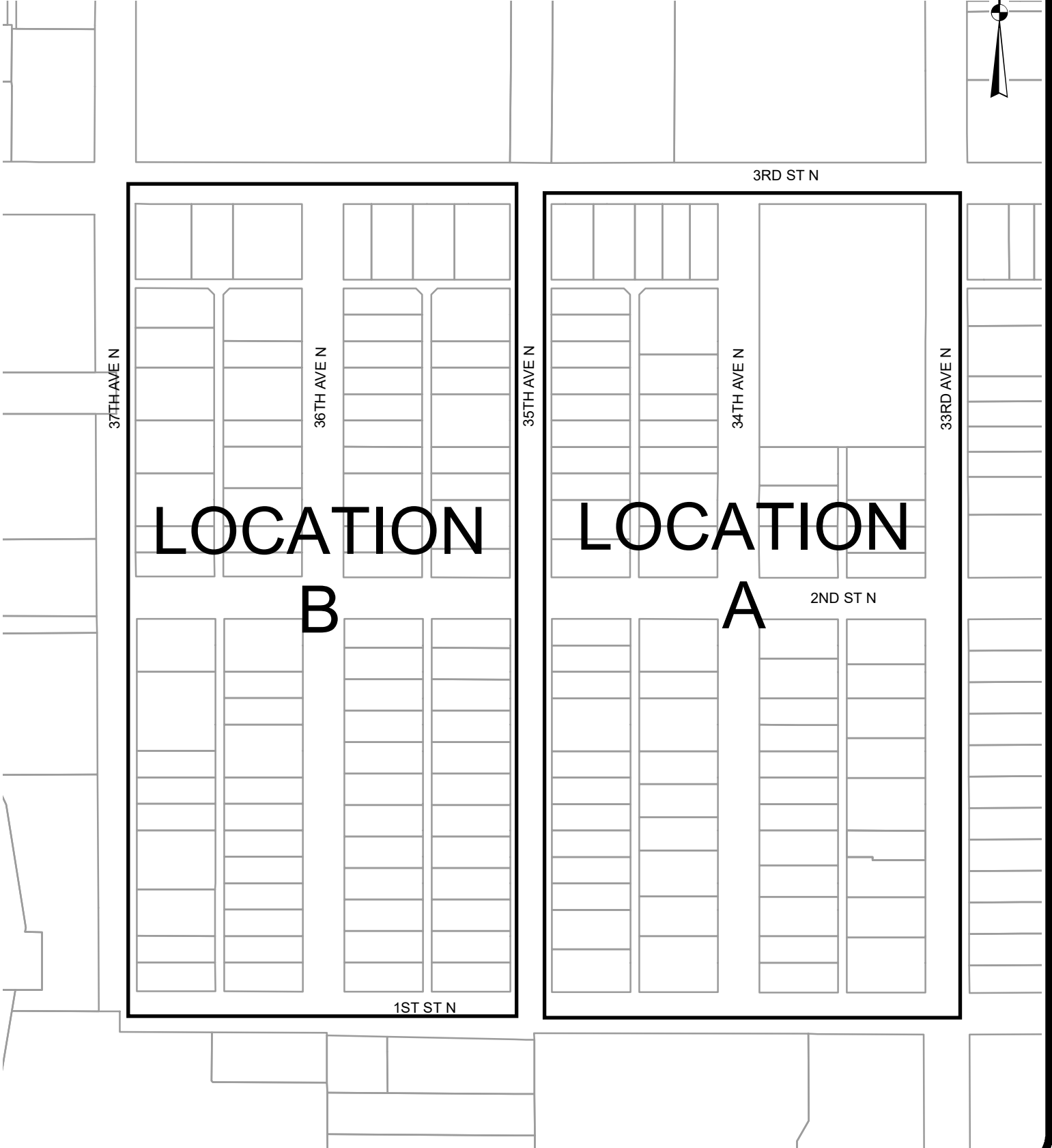

LOCATION

B

LOCATION

A

37TH AVE N

36TH AVE N

35TH AVE N

34TH AVE N

33RD AVE N

3RD ST N

2ND ST N

1ST ST N